

Wood Edge Table Tops

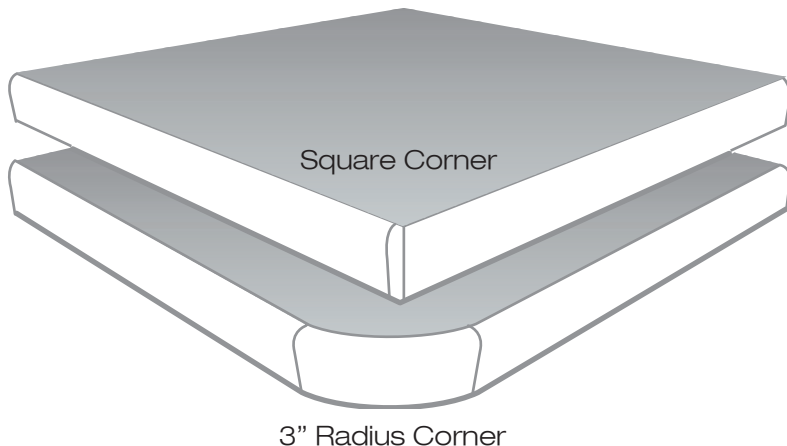

1" wide wood edge with square or radius corners (#WE-1025) or with drop edge (#WE-1075)

Corner Construction Options



EDGE THICKNESS

#WE-1025 tops are 1 1/4" thick

#WE-1075 tops have a drop edge to give the appearance of a 1 3/4" top

CORNER CONSTRUCTION

square or 3" radius

MATERIALS

horizontal grade laminate

core is 1 1/8" thick 45 pound density particle board

underside is sealed with an acrylic backing sheet

wood edge finish is quality, high solids, conversion varnish

Standard Profiles

#WE-1025

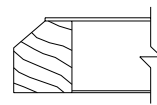

Bevel

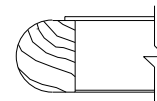

Bullnose

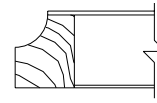

Cove

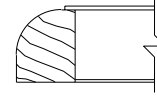

Rolled

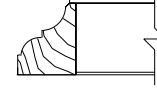

Inset Ogee



Waterfall

Drop Edge Profiles

#WE-1075

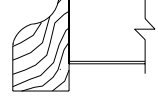
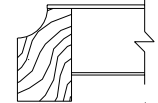
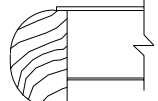
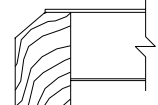

waymar

www.waymar.com

© 2008 Waymar Industries, Inc.
14400 Southcross Drive West
Burnsville, Minnesota 55306
800.328.4299
800.367.1366 fax